



WITH A STRIKING EXTERNAL APPEARANCE THAT CAPTURES THE ESSENCE OF THIS ULTRA-MODERN HOLIDAY HOME, THE MERIDIAN LODGE IS SETTING THE STANDARD FOR LUXURY, REFINEMENT AND OVERALL BUILD QUALITY

The contemporary styling of the Meridian Lodge combines large living areas with distinctive furnishings to deliver a unique ambience with an overwhelming sense of space.

Relax in comfort on the modern chenille three piece suite whilst taking in the modern décor inspired by the latest design trends. You can choose to replace one of the feature bay windows to the front of this model with Outlook French doors to optimise the layout to suit your requirements.

The fresh, clean lines of the fully-featured kitchen are accentuated by the daylight that streams in through the incredible feature windows of the dining area.

There are plenty of surprises in the bedrooms. The elegant doors within the main bedroom of the two bedroom model open to reveal an enormous en-suite bathroom and a spacious walk-in wardrobe. Both models feature flexible twin bedroom accommodation with off-set beds and useful dressing table areas.

Super insulated, the Meridian Lodge delivers staggering energy efficiency whilst effortlessly maintaining a commanding presence that would grace any location.

MERIDIAN LODGE FEATURES

EXTERIOR/STRUCTURE

- Energy efficient white PVCu double glazed windows and doors
- High performance rigid vinyl cladding
- Heavy duty galvanised chassis (twin axle)
- Composite insulated floor structure
- 100mm external wall structure
- Steel pantile pitched roof
- Underfloor insulation and lagged water pipes
- Modern PVCu gutters and fall-pipes
- Exterior lights

INTERIOR FEATURES

- Gas combi boiler central heating system incorporating radiators with temperature control valves
- Vaulted ceilings throughout
- Energy efficient lighting

LOUNGE

- Freestanding three piece suite with fold-out occasional sofa bed and scatter cushions
- Flame effect electric fire
- Wall mounted TV point (bracket not included)
- Feature coffee table
- Framed wall art
- Feature display cabinet

KITCHEN

- Integrated side-by-side under counter fridge and freezer
- Integrated microwave oven/grill
- High-level dual oven/grill
- 5 burner hob with wok burner and auto ignite
- Chrome and curved glass cooker hood
- 1 1/2 bowl linen finish stainless steel sink
- Laminate tile flooring

DINING AREA

- Freestanding dining table
- High-backed upholstered dining chairs
- Feature vaulted ceiling canopy
- Laminate tile flooring

MAIN BEDROOM

- Kingsize bed with lift-up storage system (two bedroom model)
- Double bed with lift-up storage system (three bedroom model)
- Walk-in wardrobe
- Co-ordinating bedding set
- Flat screen TV point

TWIN BEDROOM(S)

- Space saving fold-under bed (one supplied in three bedroom model)
- Co-ordinating bedding sets
- Built-in dressing table

FAMILY SHOWER ROOM

- 1200 x 800 shower enclosure with thermostat controlled shower (two bedroom model)
- Quad shower cubicle with thermostat controlled shower (three bedroom model)
- Dual flush WC
- Water saving taps
- Extractor fan

EN-SUITE (TWO BEDROOM MODEL ONLY)

- Bath with thermostat controlled shower over and bi-fold shower screen
- Dual flush WC with concealed cistern

REGULARLY SPECIFIED OPTIONS

- Outlook French doors
- Washer/dryer or slimline dishwasher
- Woodland Meridian Lodge model (natural timber cladding)
- 'Environmental Green' exterior and window frames



TV, toaster and coffee maker not included



TV and table lamp not included
Available with optional Outlook French doors



Optional Outlook French doors



Standard window model





Kettle and toaster not included



Coffee maker not included

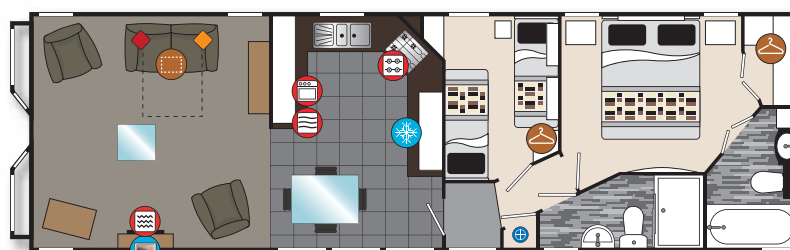

42 X 13 2 BEDROOM SLEEPS 6

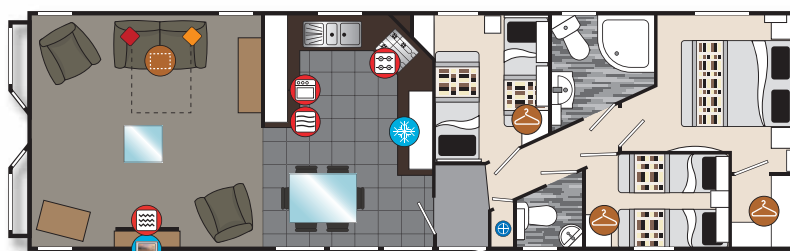

42 X 13 3 BEDROOM SLEEPS 8

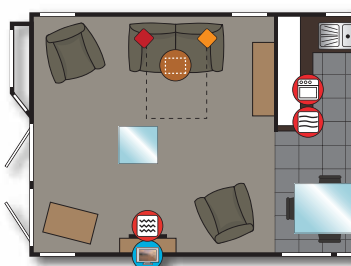

OUTLOOK

Both models available with
Outlook French doors

ICON KEY

TV Space

Hob

Boiler

Electric Fire

Fridge-Freezer

Cooker

Fold-out bed

Microwave

Wardrobe



Please refer to page 65 for the features/options comparison chart
External dimensions can be found on page 67

